

B O Y D



SOLEIL CEILING MEDIUM

#10240

SHOWN IN SATIN COPPER

DENNIS MILLER ASSOCIATES
200 Lexington Avenue Suite 1210 New York, NY 10016
212.684.0070 Fax.212.684.0776 www.dennismiller.com

10241 Soleil Ceiling Large

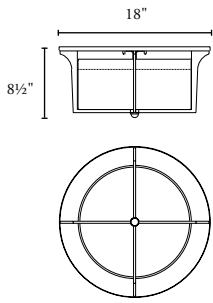

Height	Diameter	Net Wt.
8 1/2"	18"	15 lbs
216 mm	457 mm	6.8 kg

Shade: 6" H x 13 1/2" dia; 152 x 343 mm
 UL listed (or equivalent) for damp locations
 Shade: white rayon/acetate blend with 1/4" external top banding
 Bottom diffuser: white acrylic

LAMPING

Incandescent
 • Three, Medium base, A-19, 60w max each
 • Compatible with LED Screw-in lamps

Lamps not included with fixture

LED: GU-24 Base lamping may be able to meet current energy legislation; available upon request

STANDARD FINISHES

- Antiqued Copper
- Satin Copper

SPECIALTY FINISHES

- Satin Nickel

10240 Soleil Ceiling Medium

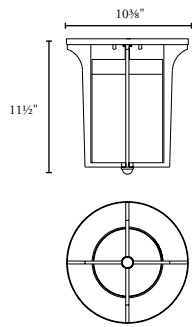

Height	Diameter	Net Wt.
11 1/2"	10 3/8"	7.5 lbs
292 mm	264 mm	3.4 kg

Shade: 8 3/4" H x 6" dia; 222 x 152 mm
 UL listed (or equivalent) for damp locations
 Shade: white cased glass with 1/4" top banding
 Bottom diffuser: white acrylic

LAMPING

Incandescent
 • One, Medium base, A-19, 60w max
 • Compatible with LED Screw-in lamps

Lamp not included with fixture

LED: GU-24 Base lamping may be able to meet current energy legislation; available upon request

STANDARD FINISHES

- Antiqued Copper
- Polished Copper
- Satin Copper

SPECIALTY FINISHES

- Polished Nickel
- Satin Nickel

10236 Soleil Petite Pendant

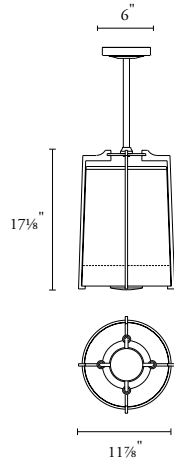

10235 Soleil Salon Pendant

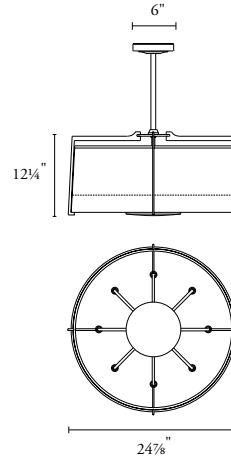

DENNIS MILLER ASSOCIATES
 200 Lexington Avenue Suite 1210 New York, NY 10016
 212.684.0070 Fax: 212.684.0776 www.dennismiller.com

