

# BERT FRANK



# BIDE

# FINISHES

Bide merges traditional raw materials such as brass and alabaster with modern engineering techniques, resulting in a harmonious blend of grace and durability. Alabaster is a natural stone and therefore each piece will feature unique veining and detailing. Standard brass finish options provided below and bespoke finishes available upon request.

## SOLID BRASS METALWORK



BRUSHED BRASS



ANTIQUÉ BRASS



DARK BRONZE



SATIN NICKEL

## STONE



ALABASTER

# WALL 180 & 280



Bide wall light 180 | Brushed Brass

## MATERIALS

Brass wall plate & front detail | Alabaster disc

## FINISHES

Standard finishes listed below.  
Bespoke finishes available upon request.  
Metalwork lacquered as standard.

## DIMMING

Mains dimmable | TRIAC

## IP RATING

IP65 rated, suitable for wet areas

## LIGHT SOURCE

6W as standard | 10W option available | 2700k  
Integrated 110/230V Mains LED

## DIMENSIONS

Size I |  $\varnothing$  180mm |  $\varnothing$  7in  
2.3kg | 5.1lbs

Size II |  $\varnothing$  280mm |  $\varnothing$  10in  
3.4kg | 7.5lbs

## WALL PLATE

wall plate  $\varnothing$  116mm |  $\varnothing$  4.6in

## FINISHES

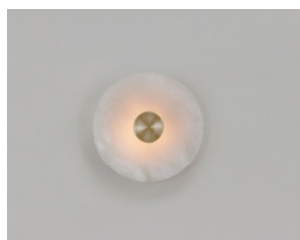

180 | BRUSHED BRASS



180 | ANTIQUE BRASS



280 | DARK BRONZE



280 | SATIN NICKEL

## LINE DRAWINGS

### BIDE 180

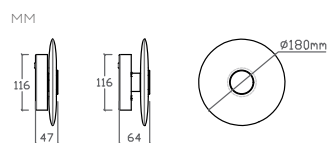

### INCHES

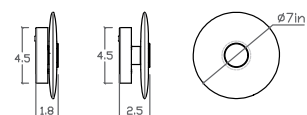

### BIDE 280

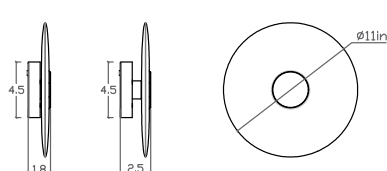
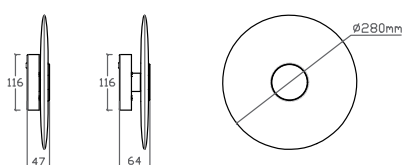

# BERT FRANK

+44 (0) 207 164 6482 | [sales@bertfrank.co.uk](mailto:sales@bertfrank.co.uk)  
[www.bertfrank.co.uk](http://www.bertfrank.co.uk) | 67 Farringdon Road, London EC1M 3JB, UK